



**3 BEDROOM SEMI DETACHED HOUSE**

**MODERN FITTED KITCHEN**

**GARAGE**

**THROUGH LOUNGE**

**MODERN BATHROOM SUITE**

**DOUBLE GLAZING**



**74 Vancouver Road**  
Edgware, HA8 5DF

**£575,000**

GROUND FLOOR  
711 sq.ft. (66.1 sq.m.) approx.

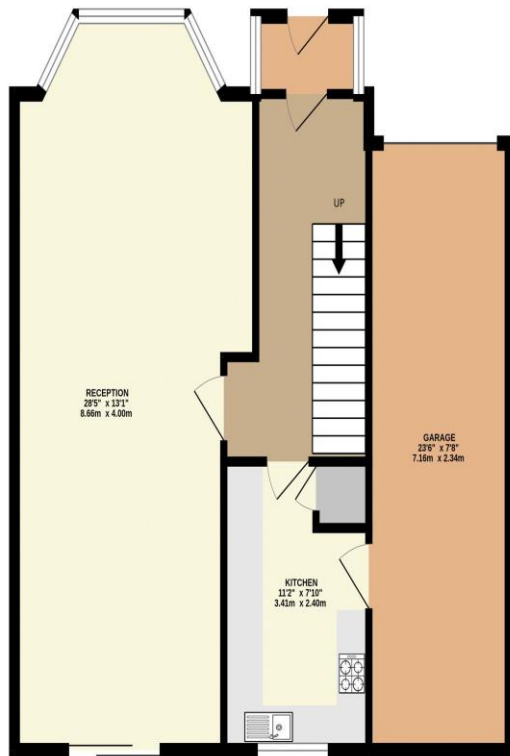

1ST FLOOR  
512 sq.ft. (47.5 sq.m.) approx.

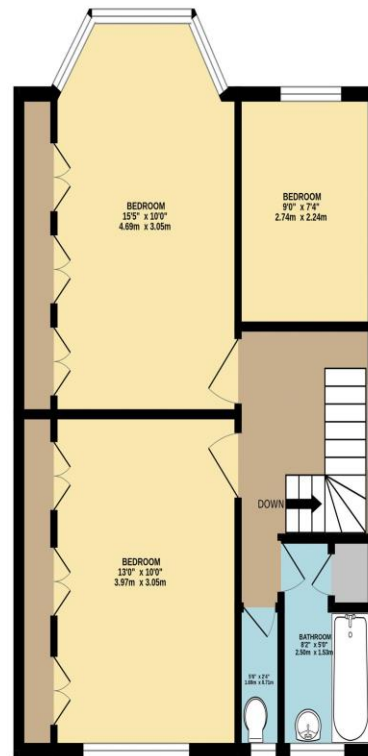

TOTAL FLOOR AREA: 1223 sq.ft. (113.6 sq.m.) approx.

Whilst every attempt has been made to ensure the accuracy of the floorplan contained here, measurements of doors, windows, rooms and any other items are approximate and no responsibility is taken for any error, omission or mis-statement. This plan is for illustrative purposes only and should be used as such by any prospective purchaser. The services, systems and appliances shown have not been tested and no guarantee as to their operability or efficiency can be given.  
Made with Metropix ©2024



## Energy performance certificate (EPC)

Vancouver Road  
EDGWARE  
HA8 5DF

Energy rating

**D**

Valid until: **28 May 2033**

Certificate number: **0350-2353-5250-2127-4755**

Property type

Semi-detached house

Total floor area

88 square metres

### Rules on letting this property

Properties can be let if they have an energy rating from A to E.

You can read [guidance for landlords on the regulations and exemptions](https://www.gov.uk/guidance/domestic-private-rented-property-minimum-energy-efficiency-standard-landlord-guidance) (<https://www.gov.uk/guidance/domestic-private-rented-property-minimum-energy-efficiency-standard-landlord-guidance>).

### Energy rating and score

This property's current energy rating is D. It has the potential to be B.

[See how to improve this property's energy efficiency.](#)

Score	Energy rating	Current	Potential
92+	A		
81-91	B		88 B
69-80	C		
55-68	D	64 D	
39-54	E		
21-38	F		
1-20	G		

The graph shows this property's current and potential energy rating.

**Properties get a rating from A (best) to G (worst) and a score.** The better the rating and score, the lower your energy bills are likely to be.

For properties in England and Wales:

the average energy rating is D  
the average energy score is 60